



Quadrant Estate Agents

£300,000



5 Worcester House, Gardeners

Bicester, OX26 6FU

An excellently presented 2 double bedroom, top floor apartment, with 3 balcony's, boasting views to north & south & allocated parking. Set within close proximity to Bicester Village Train Station & Shopping outlet. A must view to appreciate size & condition.

www.quadrant-estates.co.uk

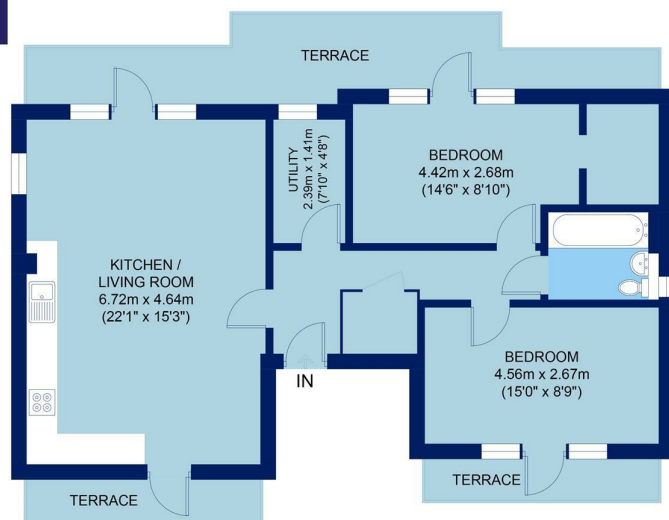

APPROX. GROSS INTERNAL FLOOR AREA 819 SQ FT / 76.1 SQ M
5 WORCESTER HOUSE

All measurements of walls, doors, windows and fitting and appliances, including their size and location, are shown as standard sizes and therefore cannot be regarded as a representation by the seller.

ACCOMMODATION

- 2 DOUBLE BEDROOMS
- KITCHEN/DINER/LIVING ROOM
- STUDY/UTILITY ROOM
- ENTRANCE HALLWAY
- 3 BALCONIES
- FAMILY BATHROOM
- ALLOCATED PARKING



10Market Square, Bicester, Oxfordshire, OX26 6AD

t 01869 241166

sales@quadrant-estates.co.uk

www.quadrant-estates.co.uk

IMPORTANT: we would like to inform prospective purchasers that these sales particulars have been prepared as a general guide only. A detailed survey has not been carried out, nor the services, appliances and fittings tested. Room sizes should not be relied upon for furnishing purposes and are approximate. If floor plans are included, they are for guidance only and illustration purposes only and may not be to scale. If there are any important matters likely to affect your decision to buy, please contact us before viewing the property.